

UNT-C 1st. FLOOR ELECTRICAL PLAN

SCALE: 1/4" = 1'-0"

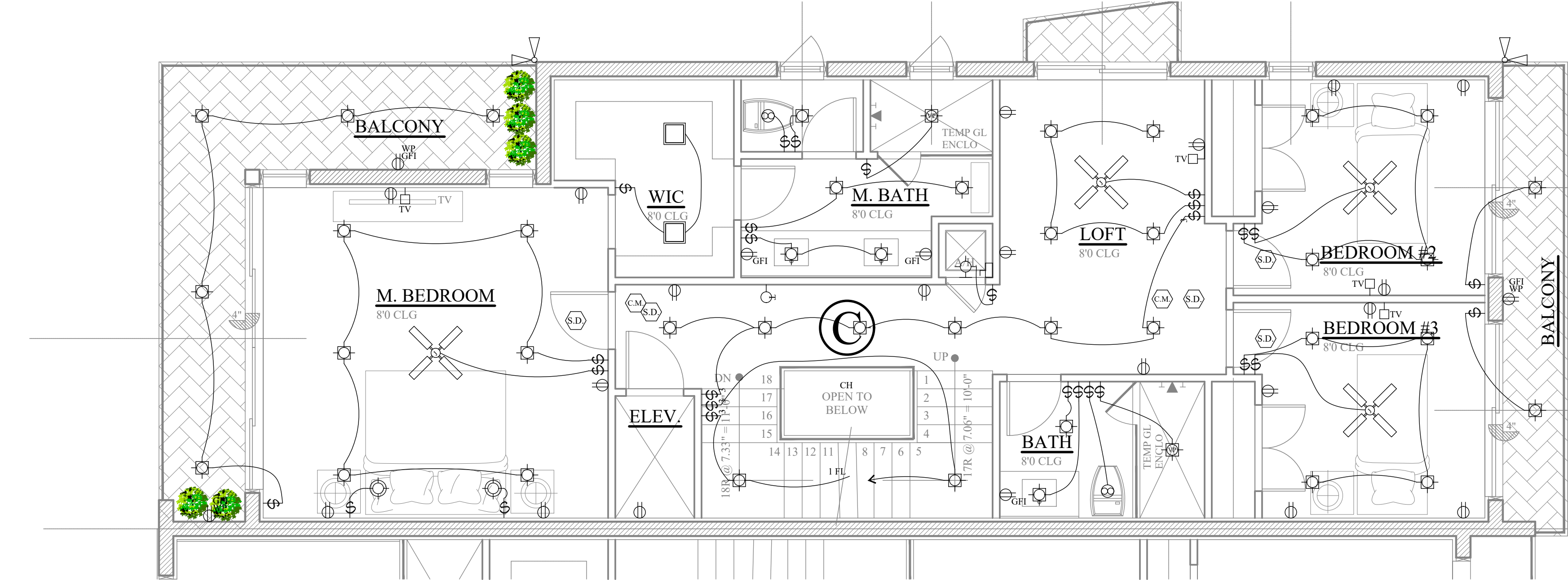

UNT-C 2dn. FLOOR ELECTRICAL PLAN

SCALE: 1/4" = 1'-0"

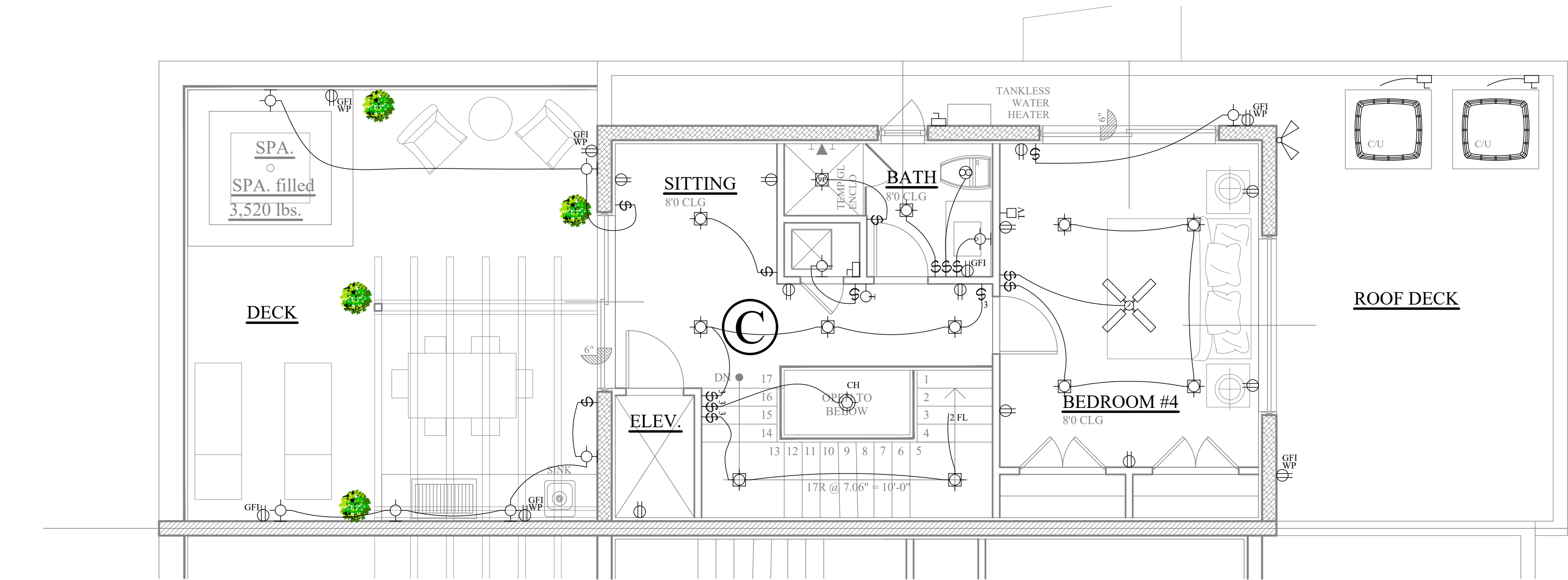

UNT-C 3rd. FLOOR ELECTRICAL PLAN

SCALE: 1/4" = 1'-0"

ELECTRICAL LEGEND			
	SINGLE RECEPTACLE		RECESSED LIGHTING 2' PIN HOLE FIXTURE
	DUPLEX RECEPTACLE		2x4 FLUORESCENT LIGHTING (SURFACE MNT.)
	HIDDEN DUPLEX RECEPTACLE		1x4 FLUORESCENT LIGHTING (SURFACE MNT.)
	GROUND FAULT INTERRUPTER		2x2 FLUORESCENT LIGHTING (SURFACE MNT.)
	WATER PROOF		ROUND FLUORESCENT
	1/2 SWITCH - DUPLEX RECEPTACLE		UNDER-CABINET OR COVE FLUORESCENT LIGHTING
	FLOOR OUTLET		TRACK LIGHTS
	QUAD RECEPTACLE		MAKE-UP LIGHTING
	220 VOLTS		GARAGE DOOR OPENER
	240 VOLTS SPECIAL PURPOSE OUTLET		CEILING PADDLE FAN FAN OUTLET ONLY W/BACKING
	SWITCH		CEILING PADDLE FAN W/BACKING (J BOX)
	3 WAY SWITCH		FLOOD LIGHTS
	4 WAY SWITCH		EXHAUST FAN
	DIMMER/RHEOSTAT SWITCH		SMOKE DETECTOR
	WATERPROOF SWITCH		CARBON MONOXIDE ALARM
	SECURITY ALARM CONTROL PAD		SPEAKER
	CABLE TELEVISION OUTLET		INTERCOM SPEAKER PANEL
	SPEAKER VOLUME CONTROL		ELECT PANEL
	DOOR BELL		ELECT METER
	GARAGE DOOR POWER BUTTON		DISCONNECT
	FIREPLACE - PRE-IGNITER		smoke detector
	PUSH BUTTON		TELEPHONE JACK
	INCANDESCENT LIGHTING SURFACE MOUNTED FIXTURE		TELEPHONE JACK - (18" A.F.F.)
	PENDANT HANGING MOUNTED FIXTURE		THERMOSTAT
	INCANDESCENT LIGHTING WALL MOUNTED FIXTURE		W/BACKING (48" MIN.)
	PULL CHAIN		
	RECESSED LIGHTING FIXTURE		
	RECESSED LIGHTING WALL-WASHER FIXTURE		
	RECESSED LIGHTING VAPOR-PROOF FIXTURE		
	RECESSED LIGHTING WATER-PROOF FIXTURE		
	RECESSED LIGHTING/ FAN COMBO FIXTURE		
	RECESSED LIGHTING/FAN/ HEATLAMP COMBO FIXTURE		

AREA CALCULATION: C	
1st FLOOR - A/C	1,092 S.F.
2nd FLOOR - A/C	1,086 S.F.
3rd FLOOR - A/C	588 S.F.
TOTAL - A/C:	2,766 S.F.
GARAGE	216 S.F.
ENTRY	43 S.F.
PATIO	66 S.F.
BALCONY 1	154 S.F.
BALCONY 2	66 S.F.
BALCONY 3	18 S.F.
UPPER DECK	828 S.F.
ROOF	588 S.F.
SUB- TOTAL:	1,979 S.F.
GRAND TOTAL:	4,745 S.F.



CAG
ARCHITECTS, LLC.

FLORIDA CERTIFICATE #AR 0017819
406 S. NEPTUNE DRIVE,
SATELLITE BEACH, FLORIDA 32937
PHONE (321) 389-8787

©2019/20
All reports, plans, specifications, computer files, field
data, notes and other documents are instruments of
service prepared by CAG Architects, LLC (C.A.G.)
as instruments of service remain the property of
C.A.G. C.A.G. shall retain all common law,
statutory and other reserved rights, including the
copyright therein. Any use or reproduction of this
document without written permission from C.A.G. is
a violation of Federal copyright laws.

Archila
Design
GROUP
ARCHITECTURE

923 San Rafael Rd. SW
Palm Bay, FL 32909
PHONE: (561) 504-4240

1602 N. RIVERSIDE DR.
TRIPLEX
POMPANO BEACH, FL.
BROWARD COUNTY, FLORIDA

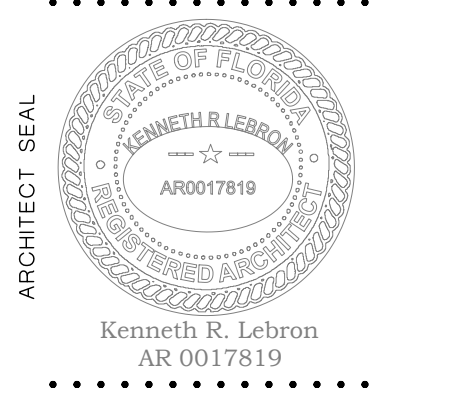

UNIT C
ELECTRICAL
FLOOR PLAN

Project Manager:
OSCAR
Drawn by: G.R.
Project No.: 24-925

10/03/2024

E-3

DRC

PZ25-12000003

05.21.2025